

## IGS Check Valves VICV2 Series

### Product Features

- W-seal
- Used for pipeline purging
- Wetted surface treated with EP, max. 5 µin. Ra
- Material: 316L Secondary Remelt
- 100% Helium leak tested



### Technical Data

Max. Working Pressure:	150 psig
Max. Working Temp:	14°F~176°F (-10°C~80°C)
Surface Finish:	Max. 5µin. Ra
Cracking Pressure:	≤0.33 psig
Resealing Pressure:	≤4 psig (Back Pressure)
Materials	
Body:	316L Secondary Remelt
Leak Rate: (Internal)	1x10 <sup>-9</sup> mbar-l/s He
(External)	1x10 <sup>-8</sup> mbar-l/s He
Flow Capacity:	Cv=0.35

\*When first used or left unopened for a long period of time, its initial cracking pressure may be higher than the set cracking pressure.

### Dimensions (mm)

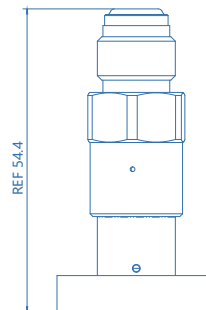
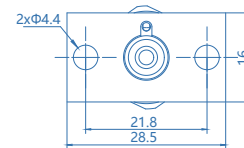

### Ordering Information

**VICV2 - MV4 - W11 - FF**

#### Inlet / Outlet Connection

MV4: 1/4" VFS male  
 FV4: 1/4" VFS female  
 W11: 1.125" W-seal

#### Sealing Material

F: FKM  
 FF: FFKM  
 E: EPDM

