

### Product Feature

- Suitable for ultra-pure, flammable or toxic fluid lines in semiconductor manufacturing equipment and facilities
- Direct diaphragm construction with superior sealing performance, remarkable durability, compactness and particle free performance
- The product is fabricated in compliance with the VS001A process specification
- Valve open and closed position is easily visible at a glance
- Excellent gas displacement characteristics
- EP treatment is standard for all wetted surfaces
- Standard seat material is PCTFE, Polyimide is option

### Temperature / Pressure Rating

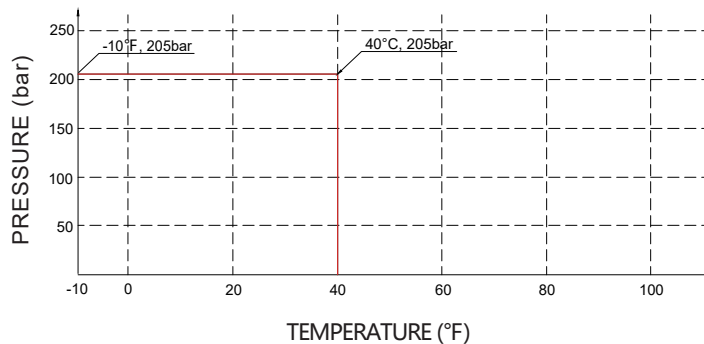

1/2" pneumatic actuator



1/2" manual actuator

### Technical Data

Operating Pressure:	3000 psig (200bar) / 1300 psig (90bar)
Actuation Pressure:	70~110 psig (5~8bar)
Max. Working Temp.:	-40°F ~ 150°F (-40°C ~ 65°C)
Surface finish:	10μin. Ra
Materials	
Body:	see ordering info
Diaphragm:	Elgiloy®
Seat packing:	PCTFE
Handle:	AL
Internal Leakage Allowance:	1x10 <sup>-9</sup> mbar l/s He
External Leakage Allowance:	1x10 <sup>-9</sup> mbar l/s He
Flow capacity:	manual actuator Cv=1.0 pneumatic actuator Cv=1.0 (90bar) / Cv=0.7 (206 bar)
Weight:	approx. 1.36kg (depending on connections or options)



## Dimensions (mm)

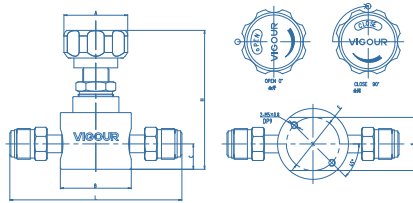

manual actuator (90 bar)

End Conections	Orifice (mm)	Dimensions (mm)							
		A	B	C	E	F	L	H	
1/4" VFS male	4.4	Φ47.8	50.8	18.2	Φ38.1	38	102	100	
1/4" VFS female	4.4	Φ47.8	50.8	18.2	Φ38.1	38	102	100	
1/2" VFS male	7	Φ47.8	50.8	18.2	Φ38.1	38	123	100	
1/2" VFS female	7	Φ47.8	50.8	18.2	Φ38.1	38	123	100	
3/4" VFS male	7	Φ47.8	50.8	18.2	Φ38.1	38	178	100	
3/4" VFS female	7	Φ47.8	50.8	18.2	Φ38.1	38	178	100	

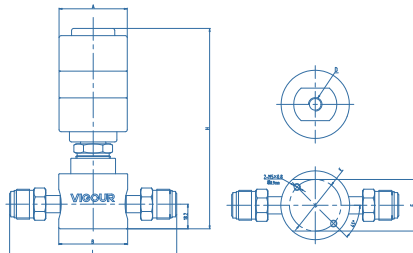

pneumatic actuator (normally closed 90 bar)

End Conections	Orifice (mm)	Dimensions (mm)							
		A	B	C	D	E	F	L	H
1/4" VFS male	4.4	Φ50.3	50.8	18.2	1/8" NPT	Φ38.1	38	102	148
1/4" VFS female	4.4	Φ50.3	50.8	18.2	1/8" NPT	Φ38.1	38	102	148
1/2" VFS male	7	Φ50.3	50.8	18.2	1/8" NPT	Φ38.1	38	123	148
1/2" VFS female	7	Φ50.3	50.8	18.2	1/8" NPT	Φ38.1	38	123	148
3/4" VFS male	7	Φ50.3	50.8	18.2	1/8" NPT	Φ38.1	38	178	148
3/4" VFS female	7	Φ50.3	50.8	18.2	1/8" NPT	Φ38.1	38	178	148

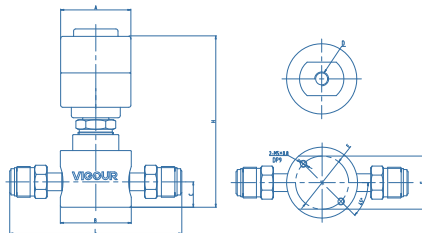

pneumatic actuator (normally closed 206 bar)

End Conections	Orifice (mm)	Dimensions (mm)							
		A	B	C	D	E	F	L	H
1/4" VFS male	4.4	Φ50.3	50.8	18.2	1/8" NPT	Φ38.1	38	102	125
1/4" VFS female	4.4	Φ50.3	50.8	18.2	1/8" NPT	Φ38.1	38	102	125
1/2" VFS male	7	Φ50.3	50.8	18.2	1/8" NPT	Φ38.1	38	123	125
1/2" VFS female	7	Φ50.3	50.8	18.2	1/8" NPT	Φ38.1	38	123	125
3/4" VFS male	7	Φ50.3	50.8	18.2	1/8" NPT	Φ38.1	38	178	125
3/4" VFS female	7	Φ50.3	50.8	18.2	1/8" NPT	Φ38.1	38	178	125

## Ordering Information

**VDV38UBS - M - MV8 - MV8 - VS - H**

### Materials

S: 316L  
SLV: 316L secondary remelt

### Actuator

M: manual actuator  
PC: pneumatic actuator (normally closed)

### Work Pressure

H: 3000 psig  
M: 1300 psig

### Valve Seat Option

None: PCTFE (standard)  
VS: Vespe<sup>®</sup>

### End Connection

MV4: 1/4" VFS male	MV8: 1/2" VFS male
FV4: 1/4" VFS female	FV8: 1/2" VFS female
TW4: 1/4" tube weld	TW8: 1/2" tube weld
MV6: 1/2" VFS male 3/8" O.D.	MV12: 3/4" VFS male
FV6: 1/2" VFS female 3/8" O.D.	FV12: 3/4" VFS female
TW6: 3/8" tube weld	TW12: 3/4" tube weld

\* Other connection standard, consult factory

